

**A Friendly Reminder:**

# 24 HOURS TO SHOVEL SIDEWALKS

St. Paul Ord. No. 17187, 11-27-84

Hi – I’m a neighbor who relies on sidewalks being clear of snow and ice so that it’s easy to get around safely.

Our city requires that snow be removed from sidewalks within **24 hours after a snowfall.**

Not clearing walks can cost you a lot in fines and fees, so please see the other side of this card for helpful tips and resources.

**Turn over for important information**

**Who Needs to Shovel?**

Owners and occupants with businesses or properties bordering public sidewalks.

**When to Shovel**

Snow and ice need to be cleared from sidewalks within **24 hours after a snowfall.**

**Where to Shovel**

Clear the full width of the sidewalk. Salt or sand icy spots and remove snow from sidewalk corners and curb ramps. Consider helping out by clearing around bus stops and fire hydrants.

**What Happens if I Don't Shovel?**

- ❄️ You may receive a notice from the city
- ❄️ If you don't comply, you could be charged for snow removal services *and* fined



**Need Help?**

If you don't have the ability to shovel, call the number below to see if there is a Senior Chore Program in your neighborhood.

**Questions?**

Call the City of St. Paul Information & Complaints Office at **651-266-8989**

Or visit [smart-trips.org/sidewalks](http://smart-trips.org/sidewalks)

**Steps to create a doorhanger**

1. Print this page in color or B&W
2. Cut along the dotted line to separate this instruction panel

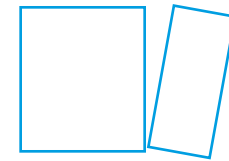

3. Fold the square panel in half

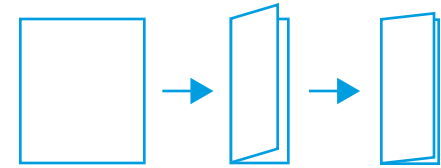

4. Seal the long edge with tape



5. Flip & cut along the dotted square

